

# Sound Processor Magnet Selection Guide

Cochlear™ Baha® Sound Processor Magnets are available with different magnetic strengths (see Figure 1) and it is very important to choose a strength that is appropriate for each individual patient. If the magnet is too weak, the sound processor may fall off, and if it is too strong, the patient may feel discomfort or experience soreness and irritation of the skin.

## Selecting the Appropriate Sound Processor Magnet

**NOTE:** It is advisable to attach a safety line to the sound processor before selecting the appropriate Sound Processor Magnet as the sound processor and magnet may fall off during the fitting process. If the patient is likely to use accessories attached to the sound processor, attach the relevant accessory when selecting a magnet, as weight will be added and this may affect the choice of magnet strength. The retention force will increase during the first 5-10 min. of wearing because the Baha SoftWear™ Pad\*\* is gradually compressed as it adapts to the surface of the skin. Therefore, it's recommended that the patient wears the selected Sound Processor Magnet for 5-10 min. before the final decision on the magnet strength is made.

## Selection Process

- Attach the sound processor to a Sound Processor Magnet (see Figure 2). Start with the Sound Processor Magnet listed as START for the correlating soft tissue thickness (see Figure 1). Always start with the Sound Processor Magnet 1 or 2 if the soft tissue thickness is unknown.
- Locate the implant magnet beneath the skin and place the Sound Processor Magnet over it, ensuring the arrow is pointing to the top of the patient's head. This will ensure it is properly positioned (see Figure 3).
- Ask the patient to move and shake his/her head as they would in normal day-to-day activities. If the sound processor falls off, try a stronger magnet (START → NORMAL → EXTRA) until the sound processor remains securely in place. The Sound Processor Magnet listed as NORMAL for the correlating soft tissue thickness will, in most cases, provide sufficient retention. The EXTRA may be needed if, for example, the patient has a lot of hair underneath the Sound Processor Magnet.
- During the selection process, also check with the patient if the Sound Processor Magnet causes any discomfort. This may indicate that a weaker magnet should be used.

**NOTE:** If Sound Processor Magnet 1 causes discomfort, attach one extra Baha SoftWear Pad and evaluate its retention and comfort. If retention is not sufficient, attach one extra pad to Sound Processor Magnet 2 and reevaluate retention and comfort.

## Patient Recommendations

During the first weeks after fitting it is recommended that the patient starts wearing the sound processor for only a few hours per day. Wearing times should then be gradually increased to allow the skin to adapt to the pressure from the Sound Processor Magnet. If any irritation is noted the Sound Processor Magnet should be removed in order to let the skin rest. If discomfort and/or skin irritation persists, the patient should contact the clinic as it may be necessary to change to a lower strength magnet.

**NOTE:** It is important to regularly check that the Sound Processor Magnet is providing sufficient retention and not causing any discomfort for the patient.

Sound Processor Magnets 1-6

Sound Processor Magnet	Soft tissue thickness			
	3 mm	4 mm	5 mm	6 mm
Magnet 6				EXTRA
Magnet 5			EXTRA	NORMAL
Magnet 4		EXTRA	NORMAL	START
Magnet 3	EXTRA	NORMAL	START	LOW
Magnet 2	NORMAL	START	LOW	LOW
Magnet 1	START	LOW	LOW	LOW
Magnet 2 with 2 SoftWear Pads	LOW			
Magnet 1 with 2 SoftWear Pads	LOW			

Figure 1: Selection of Sound Processor Magnets



Figure 2



Figure 3

\* The Cochlear Baha Attract System consists of: Cochlear Baha B1300 Implant, Cochlear Baha B1M400 Implant Magnet, Cochlear Baha Sound Processor Magnet, Cochlear Baha Sound Processor  
 \*\* Sound Processor Magnet SoftWear Pad

## Changing Baha SoftWear™ Pad

The Baha SoftWear Pad should be changed regularly. It should be changed if any of the following is observed:

- An accumulation of dirt or moisture on the pad which cannot be wiped off.
- The pad appears worn out or damaged.
- The patient experiences a gradual deterioration in wearing comfort. *(If a change of pad does not help, the patient should be instructed to contact the clinic).*

## How to Change Pads

- Remove the pad from the Sound Processor Magnet by lifting and gripping the unglued portion, then slowly release the pad from the Sound Processor Magnet (see Figure 4A).

### NOTE:

*A small section on the edge of the pad is not covered by adhesive to allow easier grip and removal. Make sure that any remains of adhesive are completely removed from the Sound Processor Magnet.*

- Select a new pad and remove the cover sheet, from the side where the soft material is slightly visible, to expose the adhesive (see Figure 4B).
- Attach it to the Sound Processor Magnet. Make sure that the pad is centralized and covers the entire Sound Processor Magnet surface (see Figure 4C).
- Remove the remaining cover sheet, that is divided in the center, before the patient starts wearing the Sound Processor Magnet (see Figure 4D).

## Sound Processor Magnet Care

- It is recommended that the Sound Processor Magnet is always worn with a Baha SoftWear Pad for maximum comfort.
- Keep the magnet and pad clean by using an alcohol-free wipe. Do not use water to clean the magnet and pad.
- Brush the snap attachment on the magnet clean with a soft brush.

## Instruct the Patient or Patient's Parents/Caregivers:

More detailed information on the points below is available in the Cochlear Baha Sound Processor Manual (*Part A*) and in the Cochlear Baha Attract System User Manual (*Part B*). These can be found in the respective Sound Processor Document Packs and in the Cochlear Baha Attract Document Pack.

- Awareness of discomfort or soreness of the skin underneath the Sound Processor Magnet.
- How to attach and remove the sound processor from the Sound Processor Magnet.
- How to place the sound processor and the Sound Processor Magnet on the head.
- How and when to change the Baha SoftWear Pad on the Sound Processor Magnet.
- How to use the safety line with the sound processor.
- Where to find the warnings and precautions page in the user manual which comes with the sound processor.

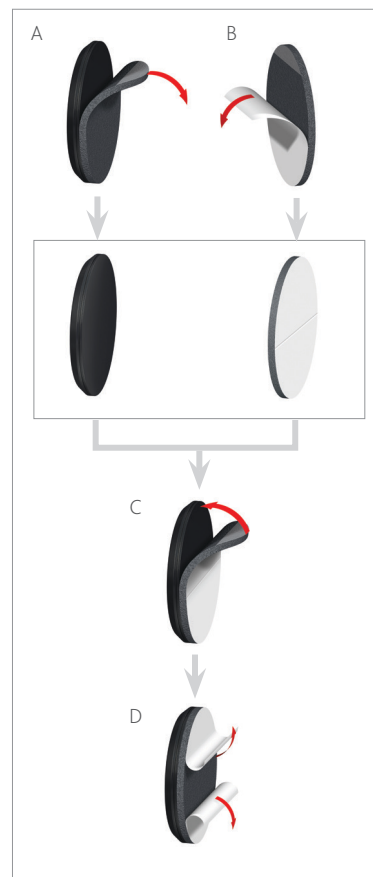

Figure 4: Changing Pads

Not everyone with hearing loss is a candidate for a Baha. All surgical procedures include an element of risk, and it is impossible to guarantee success. For complete information regarding the risks and benefits of a Baha procedure, please refer to the Instructions for use for the Baha implant available at [www.Cochlear.com/US/BahaIndications](http://www.Cochlear.com/US/BahaIndications)

[www.Cochlear.com/US](http://www.Cochlear.com/US)

### Cochlear Americas

13059 East Peakview Avenue  
Centennial, CO 80111 USA  
Telephone: 1 303 790 9010  
Support: 1 800 483 3123

### Cochlear Canada Inc.

2500-120 Adelaide Street West  
Toronto, ON M5H 1T1 Canada  
Telephone: 1 416 972 5082  
Fax: 1 416 972 5083

©Cochlear Limited 2016. All rights reserved. Hear now. And always and other trademarks and registered trademarks are the property of Cochlear Limited or Cochlear Bone Anchored Solutions AB. The names of actual companies and products mentioned herein may be the trademarks of their respective owners.



BUN225 ISS3 SEP16

Hear now. And always

