

# Cochlear™ Baha® Remote Control

## Benefits of your Cochlear Baha Remote Control

- Allows you to discreetly adjust your Baha 4 Sound Processor
- Provides large buttons for simple volume or program changes
- Allows you to monitor your or your child's sound processor
- Makes streaming to other wireless accessories easier

**Note:** The Baha Remote Control can be paired to two Baha 4 Sound Processors for those with a bilateral fitting.



## Product overview

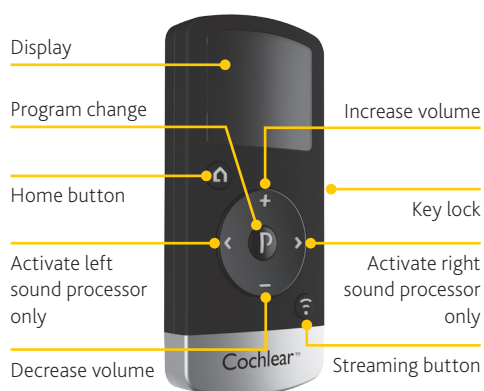

## Getting Started

Check with your hearing healthcare professional whether your sound processor has been paired with your Remote Control. Pre-paired sound processors do not need to be paired again. If your sound processor is not pre-paired, instructions on how to easily pair it with your Remote Control are on the last page of this guide.

### Installing the batteries

Remove the Remote Control battery cover and insert two AAAA batteries.

(Leave the battery cover off if you need to pair the Remote Control.)



## Using the Remote Control

### Switching between sides

Activate your left or right sound processor if you use 2 sound processors



Left side activated

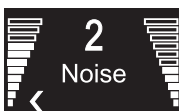

Right side activated

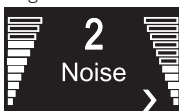

### Adjusting volume



Increase and decrease the volume of your sound processor

### Changing programs

Change programs if you have more than one program installed in your sound processor



Program examples

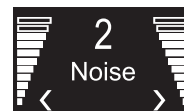
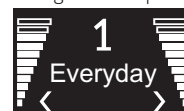



# Cochlear™ Baha® Remote Control

## Using the Remote Control

### Activating streaming

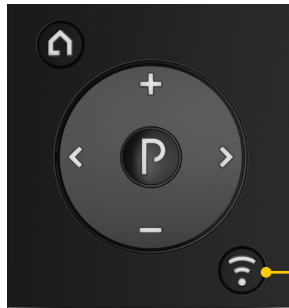

Deactivate the key lock, then press the streaming button.

If your sound processor is paired with more than one wireless accessory press once, twice, or three times to toggle between the accessories.

If you cannot connect to your wireless accessory, move closer and try again.

**Note:** To save battery consumption, the remote control display will automatically switch off after 5 seconds. Simply, press any button to turn back on and then make your adjustment.

### Deactivating streaming

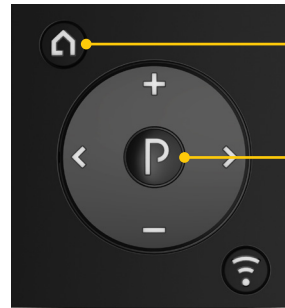

Stop streaming and return to program 1

Stop streaming and return to the previous program

### Screen examples

Searching for the wireless accessory



Connected to first wireless accessory



Connected to the second wireless accessory



Cannot find the wireless accessory



## Remote Control displays

The batteries are low and need to be replaced.

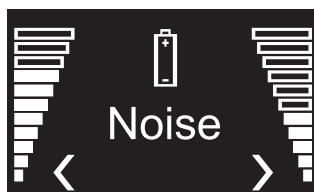

The Phone Clip is active.



The Key Lock is activated.

Slide the Key Lock button on the side of the Remote Control to unlock.



## Support

For full details about the Cochlear Baha Remote Control, please refer to the User Manual.

For full details about the Cochlear Baha 4 Sound Processor, please refer to the User Manual part A.

For further support and videos, visit the Cochlear website: [www.Cochlear.com/US](http://www.Cochlear.com/US)

# Cochlear™ Baha® Remote Control

## Pairing with your Baha 4 Sound Processor

- A** Switch off your Baha 4 Sound Processor:

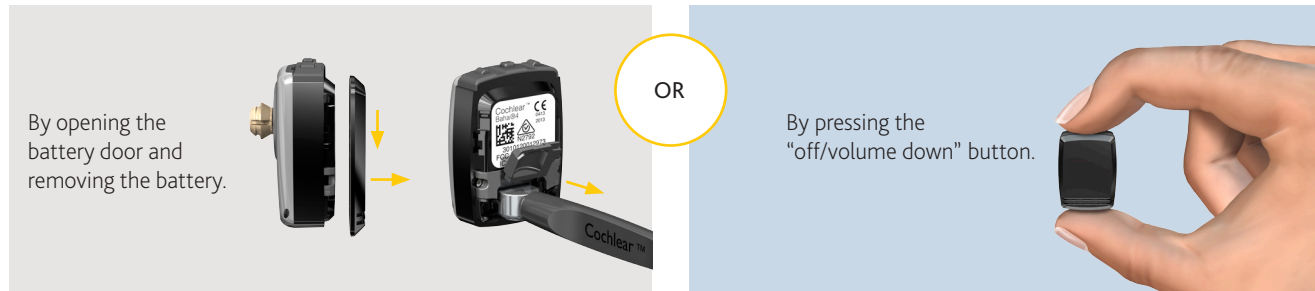

- B** Remove the battery door from your remote control.



- C** Press the pairing button on the Remote Control once using the tip of a pen or similar object.



- D** The 'search' icon will display on the screen and the Remote Control will now be in pairing mode for 20 seconds.

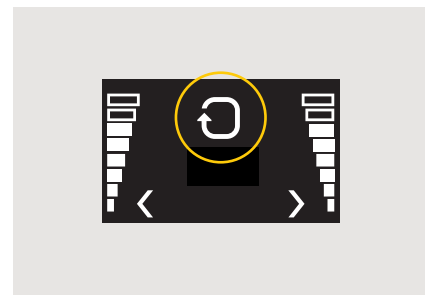

- E** While pairing mode is active, switch on your sound processor:

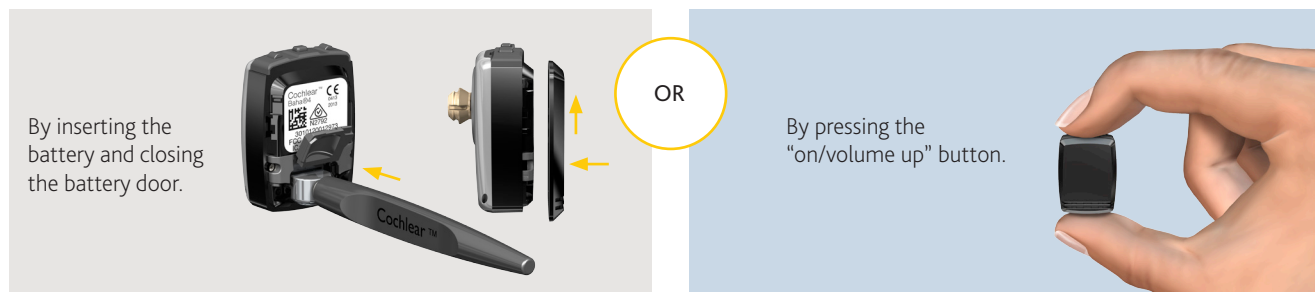

- F** Successful pairing will be indicated by an audible melody played in the sound processor.

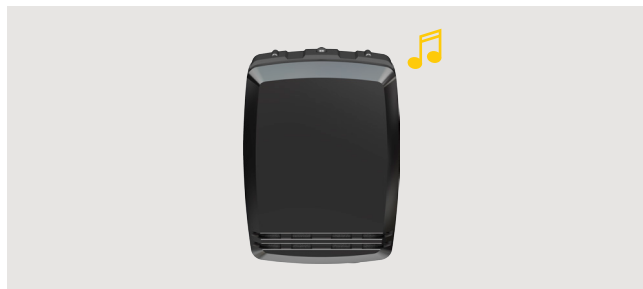

**Note:** To pair the Remote Control to two Baha 4 Sound Processors, in Step E, insert the batteries of both sound processors at the same time. Ensure an audible melody is heard from both sound processors.