

How to charge the Nucleus® 8 Sound Processor

- 1 Remove the sound processor from your head.

- 2 Remove the battery by twisting it counterclockwise.



- 4 Your charger will flash green while the battery is charging.



- 3 Ensure your Cochlear™ Y Battery Charger is plugged into the wall outlet, then twist the battery clockwise onto the charger.

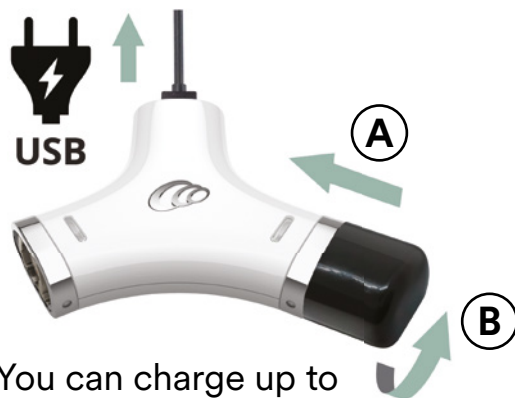

You can charge up to two batteries at one time.

- 5 When the battery is fully charged, the charger light will be steady green.



It is ready to be reconnected to your Nucleus 8 Sound Processor!

For help, call Device Support at 800 483 3123 then select option 2.

Please seek advice from your health professional about treatments for hearing loss. Outcomes may vary, and your health professional will advise you about the factors which could affect your outcome. Always read the instructions for use. Not all products are available in all countries. Please contact your local Cochlear representative for product information.

©Cochlear Limited 2023. All rights reserved. ACE, Advance Off-Stylet, AOS, Ardium, AutoNRT, Autosensitivity, Baha, Baha SoftWear, BCDrive, Beam, Bring Back the Beat, Button, Carina, Cochlear, 科利耳, コクレア, 코클리어, Cochlear SoftWear, Contour, コントウア, Contour Advance, Custom Sound, DermaLock, Freedom, Hear now. And always, Hugfit, Human Design, Hybrid, Invisible Hearing, Kanso, LowPro, MET, MP3000, myCochlear, mySmartSound, NRT, Nucleus, Osia, Outcome Focused Fitting, Off-Stylet, Piezo Power, Profile, Slimline, SmartSound, Softip, SoundArc, True Wireless, the elliptical logo, Vistafix, Whisper, WindShield and Xidium are either trademarks or registered trademarks of the Cochlear group of companies.